

SPY MURDER MYSTERY

Solve the puzzles.
Solve the crime.

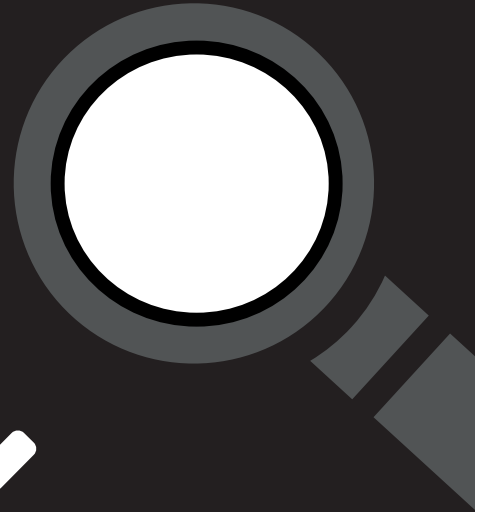
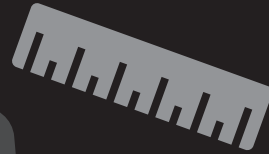

NOT CROSS

POLICE LINE DO NOT CROSS

POLICE LINE DO NOT CROSS





A MURDER HAS BEEN COMMITTED IN THE MATHS DEPARTMENT! A BODY HAS BEEN DISCOVERED SURROUNDED BY MATHEMATICAL OBJECTS AND ONLY THE HARDWORKING **MATHS TEACHERS WERE IN SCHOOL, DOING LONG DIVISION SUMS FOR THE FUN WEEKEND. SO ONE OF THEM MUST BE THE MURDERER!**

YOUR TASK, SHOULD YOU CHOOSE TO ACCEPT IT, IS TO FIND:

- 1) The Murderer
- 2) The Room
- 3) The Murder Weapon

Work quickly who knows who could be next!



Things aren't adding up so you need to work it out using your super maths logic!

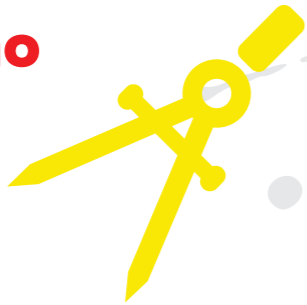

POSSIBLE SUSPECTS



Suspect 1
Ms Fraction

who was wearing a white T-shirt with 2 stripes and ripped jeans on the day of the murder.



Suspect 2
Mrs Mean

who was wearing a knee-length green skirt, with blouse and gold watch.



Suspect 3
Mr Average

who was wearing a blue Adidas T-shirt with 3 stripes on the sleeves, Bermuda shorts and a baseball cap.

POSSIBLE SUSPECTS



Suspect 4
Mr Hypotonuse

who was wearing a black and white pin-stripe suit with shiny black shoes.



Suspect 5
Mr Obtuse

who was wearing a blue knitted jumper with a picture of pi on the front, and brown cords.

POSSIBLE MURDER WEAPONS...

- 1 A wooden metre ruler
- 2 A large metal stapler
- 3 A dusty trundle wheel
- 4 A sharp compass
- 5 A large maths textbook
- 6 An oversized calculator

POSSIBLE ROOMS

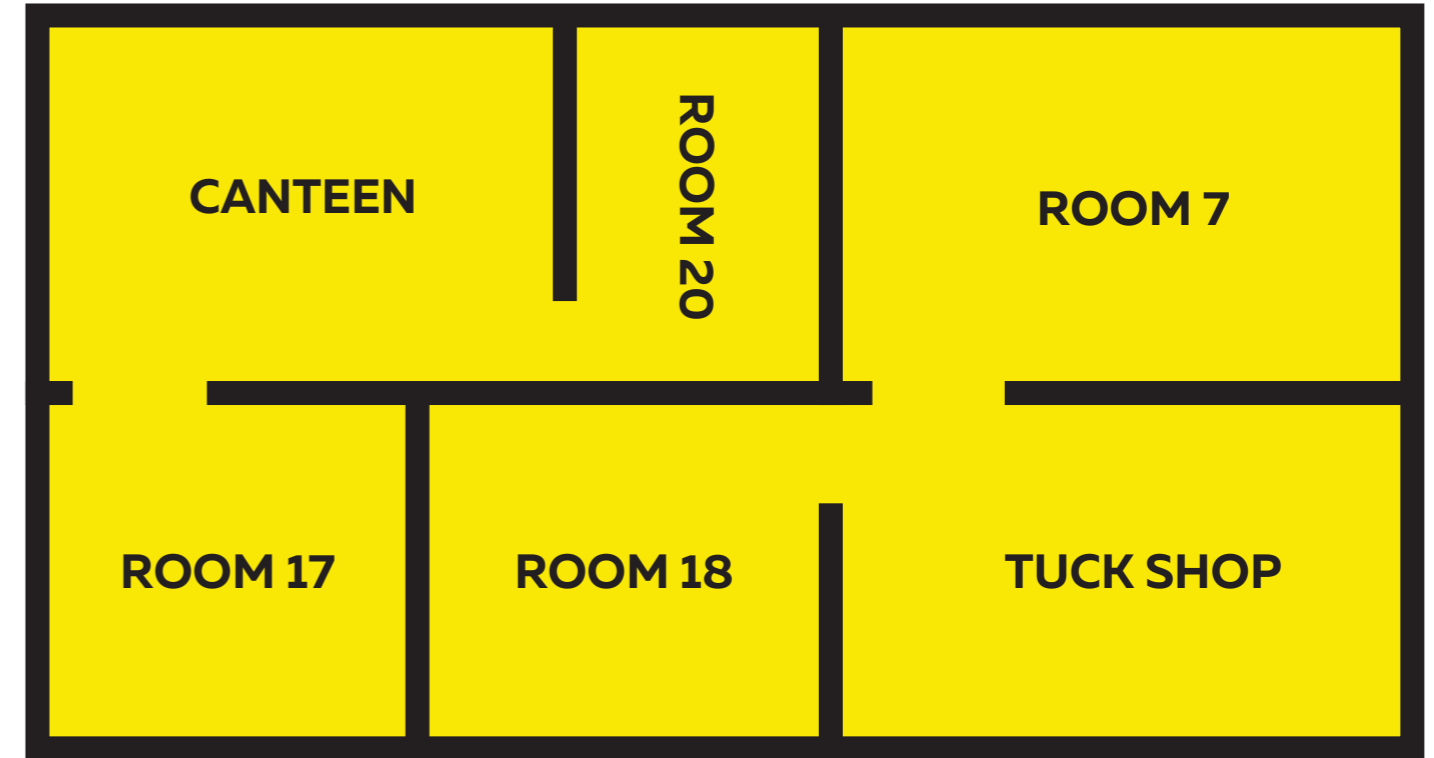

Clue Number 1 - Caesar Shift:

PDA NKKI PDA IQNZAN PKKG LHWYA EJ EO W JQIXAN

A	B	C	D	E	F	G	H	I	J	K	L	M
E	F	G	H	I	J	K	L	M	N	O	P	Q
N	O	P	Q	R	S	T	U	V	W	X	Y	Z
R	S	T	U	V	W	X	Y	Z	A	B	C	D

Clue Number 2

ht me ru ed er hr da ta po no ht ta ah sd rt pi se

Hint: Maybe letters could be swapped around somehow?

Clue Number 3

tcejbolatematonsawnopaewredrumeht



NOT

POLICE LINE DO NOT CROSS

POLICE LINE DO NOT CRO

Clue Number 4 - Pigpen Cipher:

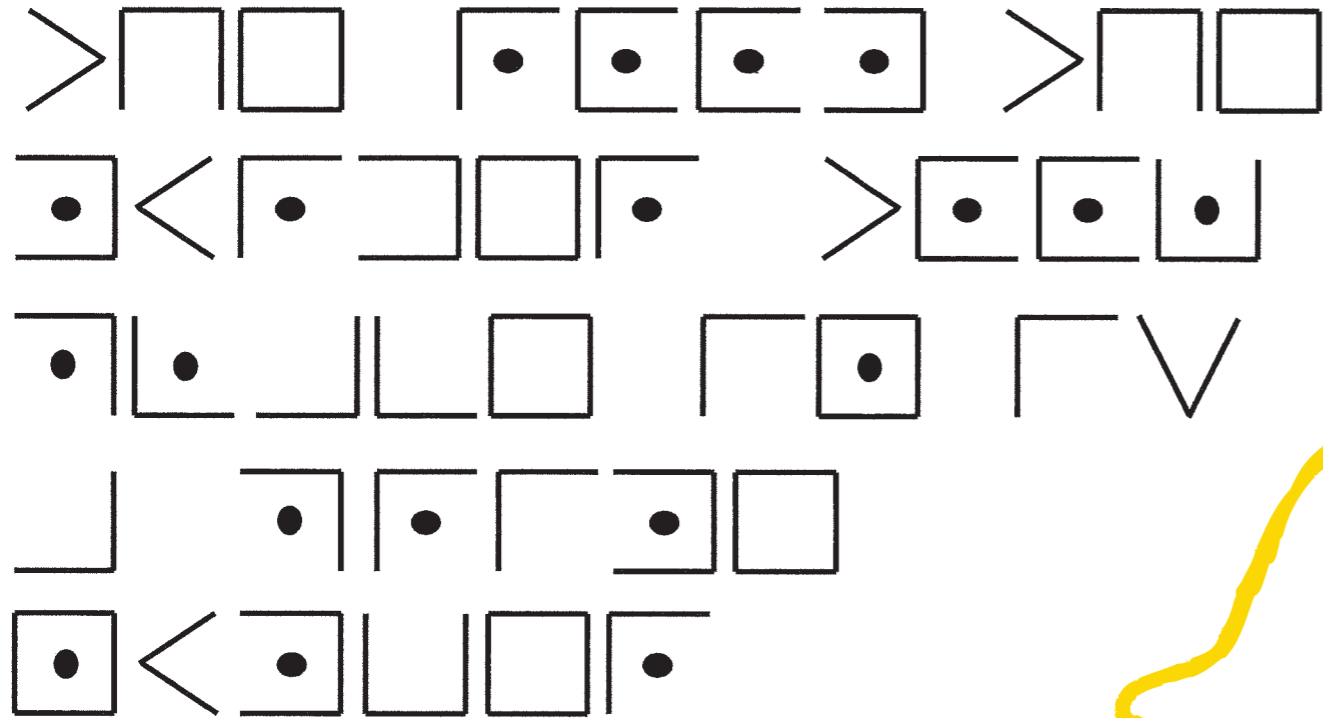

Clue Number 5

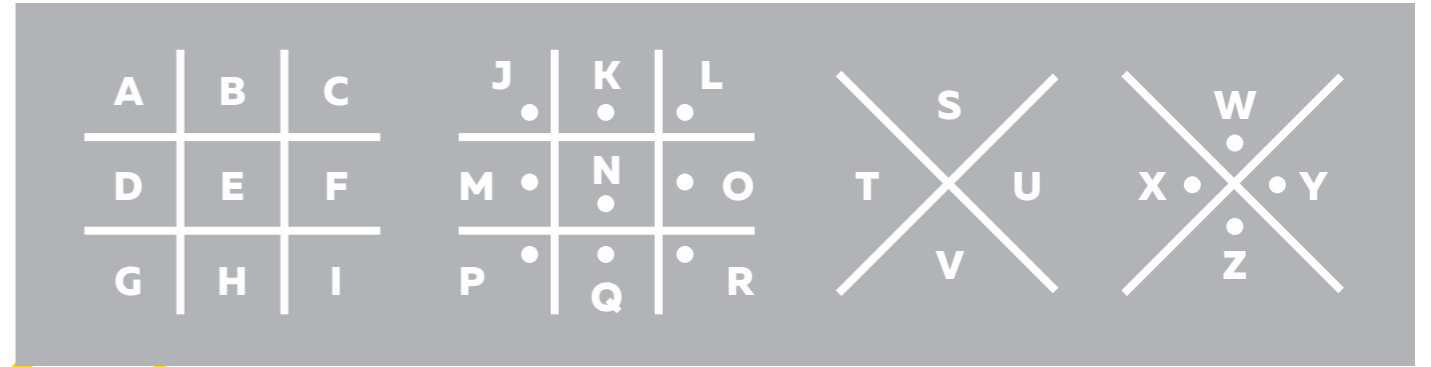

TRTURKCIURYPODUHOHRTPESSMPLNEC
IOEDOLIABAEESRKSMMEOANNENOCILY

Hint: Could splitting this in to 4 lines of equal length help?

Clue Number 6 - Morse Code:

A ● —	J ● — — —	S ● ● ●
B — ● ● ●	K — ● —	T —
C — ● — ●	L ● — ● ●	U ● ● —
D — ● ●	M — —	V ● ● ● —
E ●	N — ●	W ● — —
F ● ● — ●	O — — —	X — ● ● —
G — — ●	P ● — — ●	Y — ● — —
H ● ● ● ●	Q — — ● —	Z — — ● ●
I ● ●	R ● — ●	

1 0000 0 010 0 00 000 0110 1001 1 1000 111111 101 11 00 000 00 10 110

Clue Number 7 - Vigenere Cipher:

A	B	C	D	E	F	G	H	I	J	K	L	M	N	O	P	Q	R	S	T	U	V	W	X	Y	Z
M	N	O	P	Q	R	S	T	U	V	W	X	Y	Z	A	B	C	D	E	F	G	H	I	J	K	L
A	B	C	D	E	F	G	H	I	J	K	L	M	N	O	P	Q	R	S	T	U	V	W	X	Y	Z
T	U	V	W	X	Y	Z	A	B	C	D	E	F	G	H	I	J	K	L	M	N	O	P	Q	R	S
H	I	J	K	L	M	N	O	P	Q	R	S	T	U	V	W	X	Y	Z	A	B	C	D	E	F	G
S	T	U	V	W	X	Y	Z	A	B	C	D	E	F	G	H	I	J	K	L	M	N	O	P	Q	R

FHXTMD DXYWDWTZOQAKPFSTKVMEEKZ

Hint: Go along the M row and find F. What letter is above on the top row?
Now perhaps go to the second row...

Clue Number 8:

The number of stripes on the t-shirt is an even prime number.

Answers

Answer 1

Caesar shift A-E

THE ROOM THE MURDER TOOK PLACE IN IS A NUMBER

Answer 2

Transposition - swap every 2 grouping of letters around-so ht becomes th,

me becomes em, etc ...

The message then becomes:

The murderer had a top on that had stripes

Answer 3

Read the message backwards:

The murder weapon was not a metal object

Answer 4

The room the murder took place in is a prime number

Answer 5

Write in 4 rows of 15 characters.

Now read down the columns to get:

This room the murder took place in is a number many people consider lucky

Answer 6

1 represents a dash, 0 represents a dot.

There is a textbook missing

Answer 7

Vigenere cipher:

FHXTMDDXYWDWTZQAKPFSTKVMEEKZ

Look in the M row-find where F is, what letter is above it in the top row?

T - Look in the A row-find where the H is, what letter is above it in

the top row? H etc.

The murderer was wearing trousers

Answer 8

Upside down mirror writing:

The number of stripes on the t-shirt is an even prime number

LICE LINE DO NOT
LICE LINE

